

Mooring Cleat/Bollard for Fixation



Aluminium Alloy Cleat/Bollard

*Surface pattern on the cleat can be customized.

Material

Marine Aluminium Alloy

Features

The cast aluminum alloy mooring cleat/bollard is made of marine aluminum alloy, which can be cast once. The product itself is with good resistance of seawater corrosion and rust prevention performance, and can adapt to harsh marine environment.

Application Scope

This product can be applied to yachts and ships below 15m.

*The specifications and patterns of the cleat/bollard can be customized in accordance with drawings and samples.

*Surface logo on the cleat/bollard can be customized under requirements.

Installation Diagrams

- (1) Professional Fixation on Aluminium Alloy Pontoon
- (2) Implant Fixation in Concrete (The implant length of the bolt is greater than or equal to 10 times the bolt diameter.)

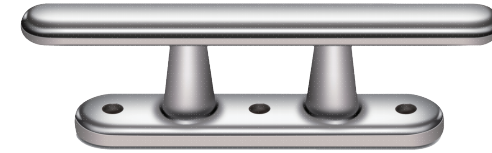
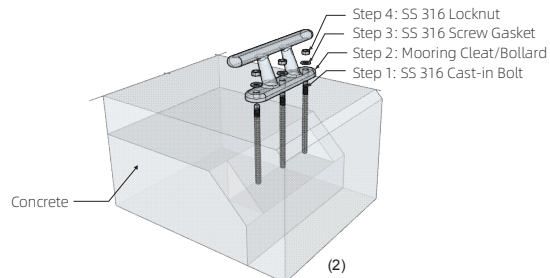
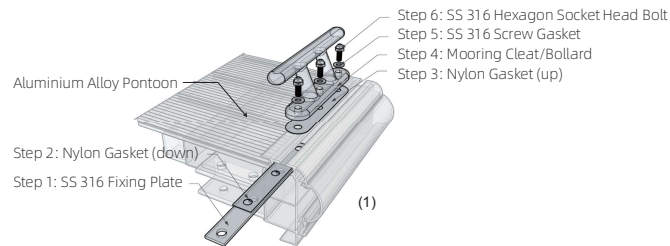

*Applicable to ships/yachts under 30 feet.

Item	A (mm)	B (mm)	C (mm)	D (mm)	E (mm)	F (mm)	G (mm)	H (mm)	Bolt Aperture (mm)	Mooring Force (kn)
ALCL-1.5T01	300	240	95.5	34	21	15	49	98.5	D14	≥15

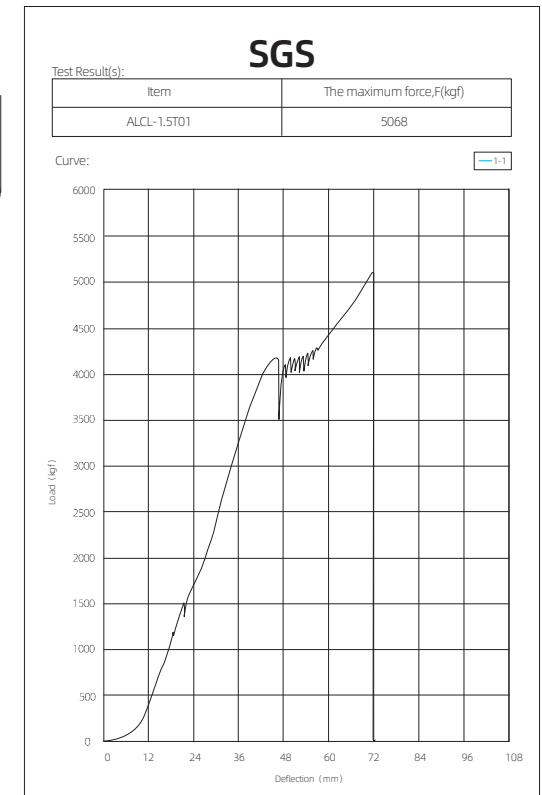
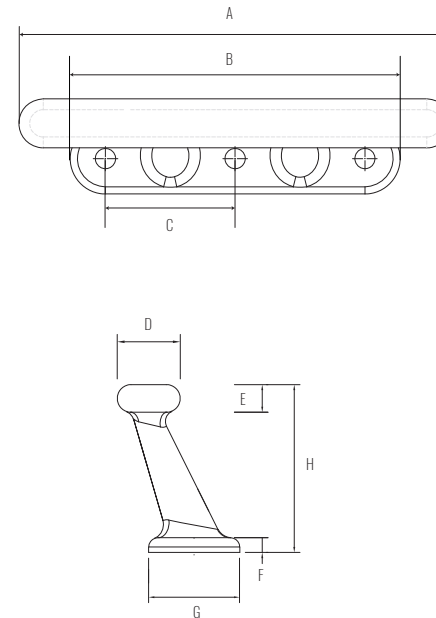

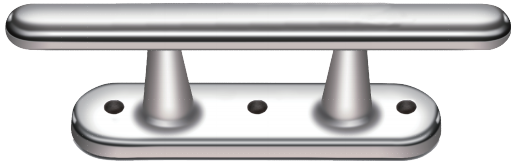

**Applicable to ships/yachts under 45 feet.*

Item	A (mm)	B (mm)	C (mm)	D (mm)	E (mm)	F (mm)	G (mm)	H (mm)	Bolt Aperture (mm)	Mooring Force (kn)
ALCL-3T01	450	360	135	45	31	20	90	169.5	D14	≥30

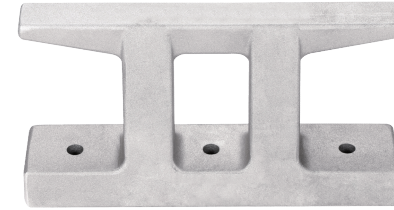
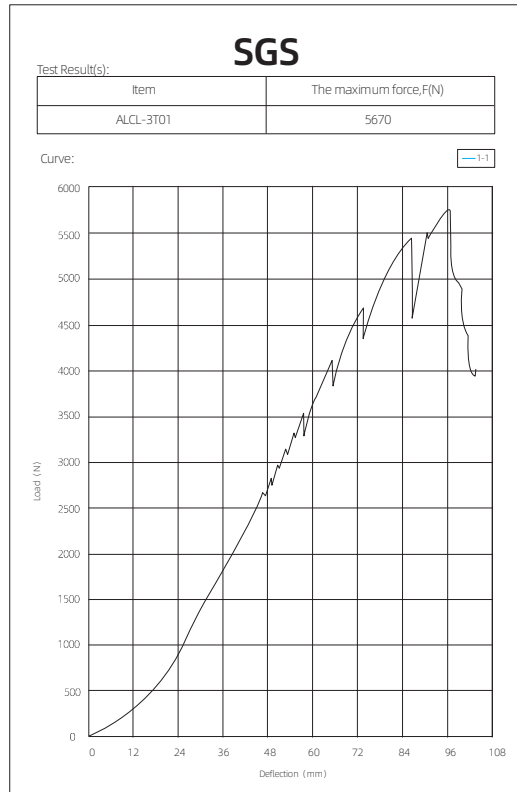
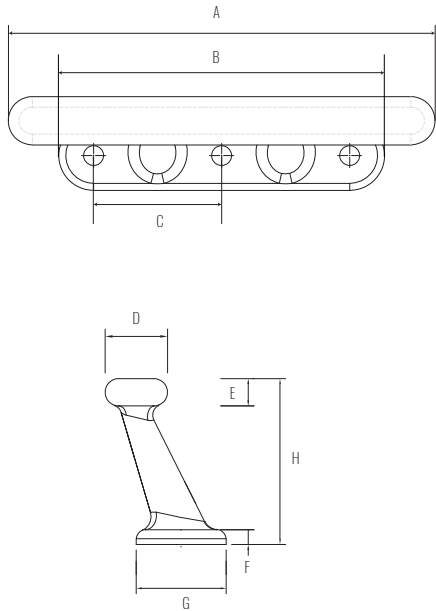

**Applicable to ships/yachts under 30 feet.*

Item	A (mm)	B (mm)	C (mm)	D (mm)	E (mm)	F (mm)	G (mm)	H (mm)	Bolt Aperture (mm)	Mooring Force (kn)
ALCL-2T02	240	240	88	28	12	24	60	120	D11	≥15

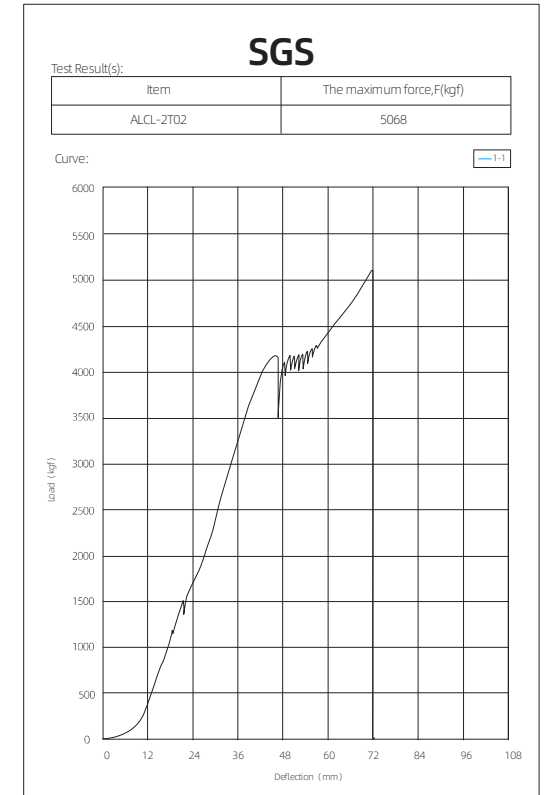
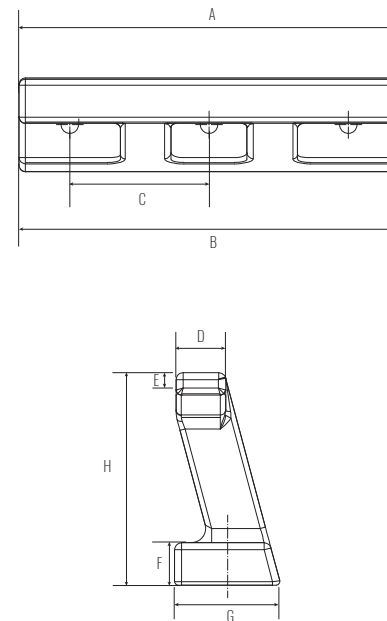

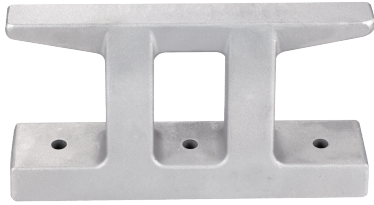

**Applicable to ships/yachts under 45 feet.*

Item	A (mm)	B (mm)	C (mm)	D (mm)	E (mm)	F (mm)	G (mm)	H (mm)	Bolt Aperture (mm)	Mooring Force (kn)
ALCL-3T02	300	300	110	35	16	30	74.2	150	D12	≥30

